

## Room Care R1-plus Pur-Eco

### Toilet cleaner - concentrate

#### Description

Concentrated cleaner for the daily toilet bowl and urinal cleaning. To be used only with Divermite/DQFM dosing and dilution system. Also available in fully recyclable mono-material pouch.

#### Key properties

- Citric acid-based formulation
- Light, delicate and fresh fragrance
- Uses unique and environmental friendly pouch technology
- Fulfills the criteria of the EU-Ecolabel scheme

#### Benefits

- Appropriate for daily use
- Effectively removes stains and deposits from toilet bowls and urinals
- Regular use hinders lime scale built-up
- Handy squeezable bottle with directional spout for fast and easy application
- Colour and alphanumeric coded to prevent application mistakes

#### Use instructions

1. Flush the toilet/urinal, reduce the water level with the toilet brush and apply the product under the rim, around the bowl, onto water/flush paths and water outlets.
2. Allow the product to act for 5 minutes; for best results leave for longer.
3. Scrub with a brush and flush to rinse.
4. Increase the acting time (1 - 2 hours) in case of heavy calcium/lime build-up.

#### Dosage\*

- When using with Divermite Room Care dosing unit, dose 1x 15ml (2%) Room Care R1- plus Pur-Eco into keyed bottle filled with 750ml of cold water. Increase concentration up to 5% (1x 15ml into keyed bottle filled with 300 ml of cold water) to remove heavy soil. Securely screw on the cap, ensure the spout is closed, and shake gently to mix.
- When using with DQFM dilution dispenser unit, fill the Room Care R1-plus Pur-Eco keyed application bottle to the fill level mark, securely screw on the cap.

Proper dosage saves costs and minimises environmental impact.

*\*This dosage is according to optimal conditions, recommendations may vary, please consult with your Diversey representative for directions.*



EU Ecolabel: DK/020/006

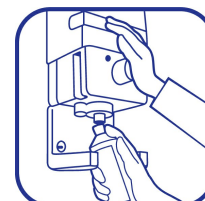



## Room Care R1-plus Pur-Eco

### Technical data

Appearance:	Clear medium blue liquid
pH value (neat):	< 2
pH value (in use):	~ 2
Relative density (g/cm <sup>3</sup> ; 20°C):	≈ 1.18

*The above data is typical of normal production and should not be taken as a specification.*

### Safe handling and storage information

Full guidance on the handling and disposal of this product is provided in a separate Safety Data Sheet; [sds.diversey.com](https://sds.diversey.com). Store in original closed containers away from extremes of temperature. Only for professional users / specialists.

### Product compatibility

Do not use on acid-sensitive surfaces, e.g. enamel, marble, grouting. Immediately remove any drops or splashes from acid-sensitive surfaces and rinse with water. Do not mix with bleach or other cleaning products. Test material compatibility in a small, inconspicuous place before use. Do not use with other dilution systems or methods. Do not use undiluted.

### Environmental information

Room Care R1-plus Pur-Eco was awarded the license (DK/020/006) fulfilling the EU-Ecolabel criteria as an environmentally friendly product.

The surfactants used in this product are biodegradable in compliance with the requirement of EU Detergent Regulation, EC 648/2004.

Fully recyclable mono-material pouch with removable label and cap, so easy to recycle where the required infrastructure exists.

### Available pack sizes

Room Care R1-plus Pur-Eco is available in a 2L pouch.

### [www.diversey.com](https://www.diversey.com)

© 2024 Diversey, Inc. All Rights Reserved. 18/03/2024 en (K00089)