



# Room Care R2-plus Pur-Eco

## Hard surface cleaner- concentrate

### Description

Concentrated cleaner for the cleaning of all water resistant hard surfaces. To be used only with Divermite/DQFM dosing and dilution system. Also available in fully recyclable mono-material pouch.

### Key properties

- Formulated for the cleaning of hard, water-resistant surfaces
- Slightly alkaline
- Non-abrasive
- Light, delicate and fresh fragrance
- Uses unique and environmental friendly pouch technology
- Fulfills the criteria of the EU-Ecolabel scheme

### Benefits

- Leaves surfaces thoroughly clean
- Quickly and gently removes oily and water-soluble residues
- Leaves a pleasant scent behind
- Colour and alphanumeric coded to prevent application mistakes

### Use instructions

Small areas: Spray a small quantity onto a damp cloth/sponge pad and clean the surface. Rinse with fresh water or wipe with a clean, damp cloth. Buff with a dry cloth for extra shine.

Large surfaces/Floor (wet cleaning): Use a sponge, cloth or mop to apply the solution onto the surface/floor, allow to act briefly (if necessary), and wipe the surface/floor clean. Rinse thoroughly with clean water and allow to dry or wipe with a rinsed in clean water, well-wrung cloth/mop. Buff with a dry cloth/mop for extra shine.

For more detailed application, please refer to Room Care R2-plus Pur-Eco Mini Guide.

### Dosage\*

When using with Divermite Room Care dosing unit, dose 1x 15ml (2%) Room Care R2- plus Pur-Eco into keyed bottle filled with 750ml of cold water or 1x 6ml (2%) into keyed bottle filled with 300ml of cold water. Securely screw on the spray trigger, ensure the nozzle is closed and shake gently to mix.

Bucket application: Dose 1x 15ml of Room Care R2-plus Pur-Eco into the dispenser ladle and pour ladle's content into 5L water (0.3%).

When using with DQFM dilution dispenser unit, fill the Room Care R2-plus Pur-Eco keyed spray bottle to the fill level mark or the bucket directly from the DQFM dispenser. Securely screw-on the spray trigger.

Proper dosage saves costs and minimises environmental impact.

*\*This dosage is according to optimal conditions, recommendations may vary, please consult with your Diversey representative for directions.*



EU Ecolabel: DK/020/006

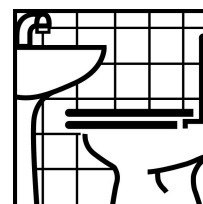
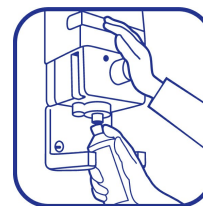

© A.I.S.E



## Room Care R2-plus Pur-Eco

### Technical data

Appearance:	Clear dark green liquid
Odour:	Slightly perfumed
pH value (neat):	~ 10
pH value (in use):	~ 11
Relative density (g/cm <sup>3</sup> ; 20°C):	≈ 1.06

*The above data is typical of normal production and should not be taken as a specification.*

### Safe handling and storage information

Full guidance on the handling and disposal of this product is provided in a separate Safety Data Sheet; [sds.diversey.com](https://sds.diversey.com). Store in original closed containers away from extremes of temperature. Only for professional users / specialists.

### Product compatibility

Do not use on water-sensitive surfaces, e.g. wood. Test material compatibility in a small, inconspicuous place before use. Do not use with other dilution systems or methods. Do not use undiluted.

### Environmental information

Room Care R2-plus Pur-Eco was awarded the license (DK/020/006) fulfilling the EU-Ecolabel criteria as an environmentally friendly product.

The surfactants used in this product are biodegradable in compliance with the requirement of EU Detergent Regulation, EC 648/2004.

Fully recyclable mono-material pouch with removable label and cap, so easy to recycle where the required infrastructure exists.

### Available pack sizes

Room Care R2-plus Pur-Eco is available in a 2L pouch.

### [www.diversey.com](https://www.diversey.com)

© 2024 Diversey, Inc. All Rights Reserved. 18/03/2024 en (K00080)